

A typical

RenoSys PVC Pool Shell

Installation

The Free Floating “Shell Within A Shell” Concept – Understanding Why It Works So Well.

PVC liners/membranes are so successful at solving pool problems due to the installation process and the way all of the components work together to create a proven, durable, watertight system. A membrane of reinforced PVC is hot air welded together inside the old pool completely eliminating: leaks, the need to paint, plaster, caulk, sandblast, scrape or hassle with the old shell's problems. Because the membrane system is completely suspended inside the old shell and does not depend on a bond with the old pool, PVC is unaffected by expansion/contraction and freeze/thaw problems like conventional renovation options. PVC has a non-porous surface making it difficult for algae to adhere thus reducing the amount of seasonal and daily cleanup. PVC also makes concrete construction cold joints watertight allowing reuse of significant portions of existing infrastructures.

Note: Although concrete is shown in this example, PVC can be applied over aluminum, steel, tile and fiberglass as well.

Step 1

The first step is surface prep. The pool should be broomed or washed clean and all depressions, spalled areas, and pitted areas are patched with vinyl concrete patch compound.

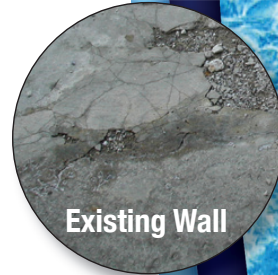

Step 2

Next, an anti-fungal agent is sprayed over the entire surface of the pool to inhibit algae and fungal growth behind the membrane.

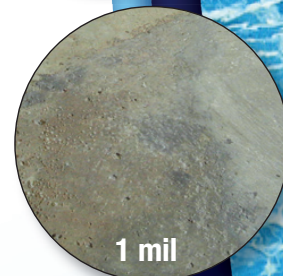

Step 3

An adhesive is then applied with a roller to hold the felt slip sheet securely in place and to keep it from sliding or shifting under the membrane.



Step 4

The felt slip sheet is rolled into place over the adhesive. It is trimmed to butt fit and to isolate and protect the membrane from the pool surface.

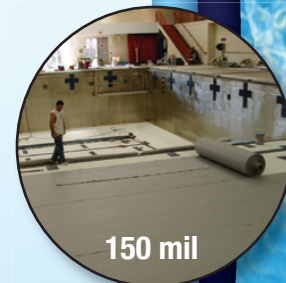

Step 5

Finally, the reinforced PVC membrane is rolled into place and welded together to form an envelope inside the old pool shell. It is adhered at the outer perimeter of the pool and in sloped areas with a waterproof adhesive. Since it is not adhered to the pool shell, it will stretch in response to pool freeze/thaw movement. Racing lanes, markings and targets are then welded over the PVC to finish off the installation.



RenoSys[®] PVC Pool Shell

Product Data and Technical Information

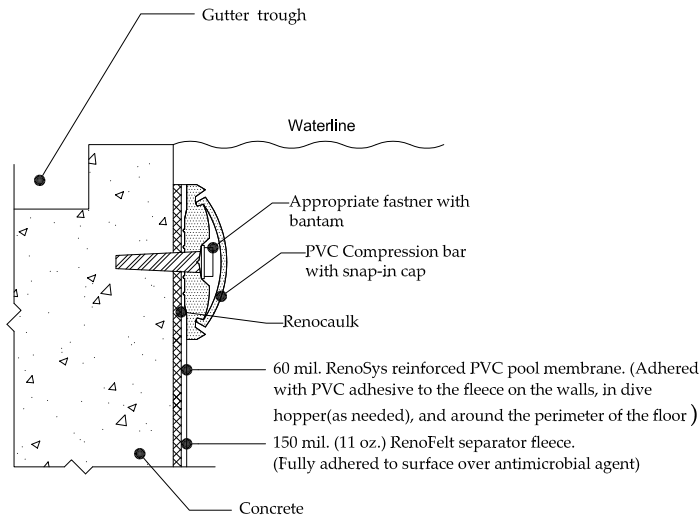

Typical Concrete Wall Termination

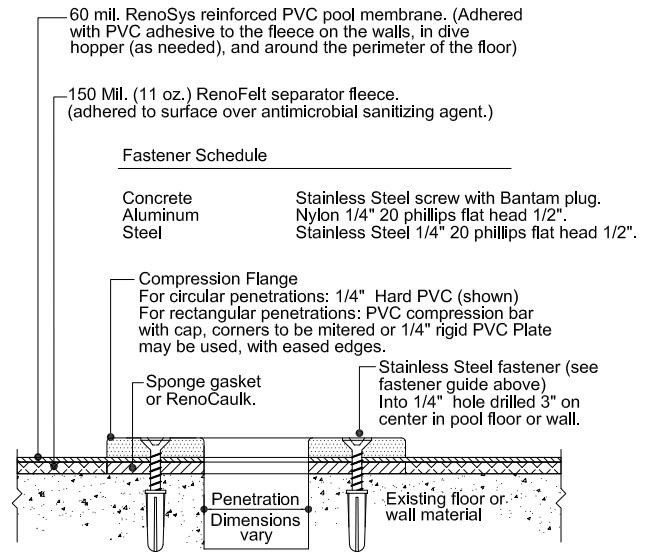

This detail used at new or existing:
Main drains, lights, inlets, wall anchors, rail posts, etc...

Typical Underwater Penetration Flange Condition

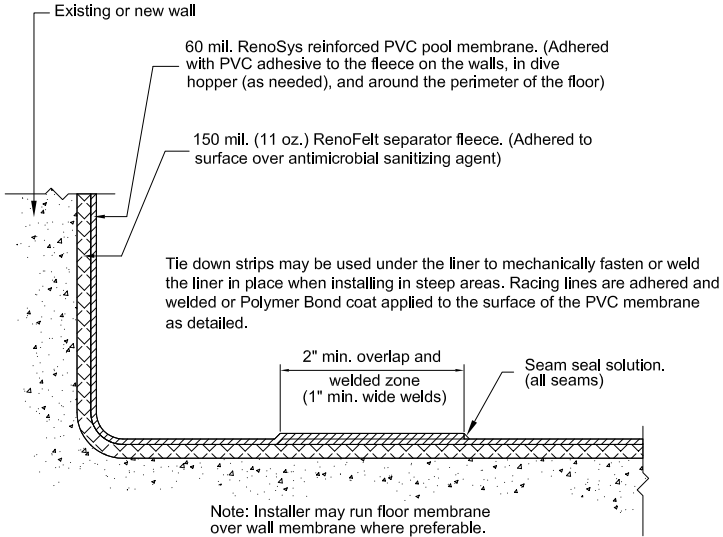

Typical Wall to Floor Junction

Technical Data:

Overall Thickness:	60 mil adhered to felt
Seams:	Lap welded
Method of Installation:	Adhered
Surface Texture:	Smooth or Textured
Warranty:	10 years
Colors:	Lt. Blue, Caribbean Blue, White, Pebble Rock, Marble, 1" Mosaic Tile
Delivery:	1 - 4 weeks

Design and Application Guide.

RenoSys complies with all applicable local, state and national codes. Roll size 6' x 82.5' x 60 mil thick. Material is manufactured with polyester reinforced for maximum puncture resistance, soil guard acrylic top coating, anti-fungal agents and is formulated specifically for the pool environment. Three textures are available. Request bid specifications, product usage guidelines, ASTM test data and construction details. Full A/E design assistance is available. The RenoSys PVC Pool Shell is warranted for a full 10 years from the date of installation.

Ordering Information: When ordering or requesting a quotation for the RenoSys PVC Pool Shell System, call 1-800-783-7005. Please have the square footage of the area to be covered when calling. We will review your requirements, provide pricing, and make installation recommendations. A written proposal, installation shop drawings, samples and details will then be provided for your approval.



2825 E. 55th Place, Indianapolis, IN 46220
800-783-7005 • www.renosys.com